

OUTBOARD PROFILE

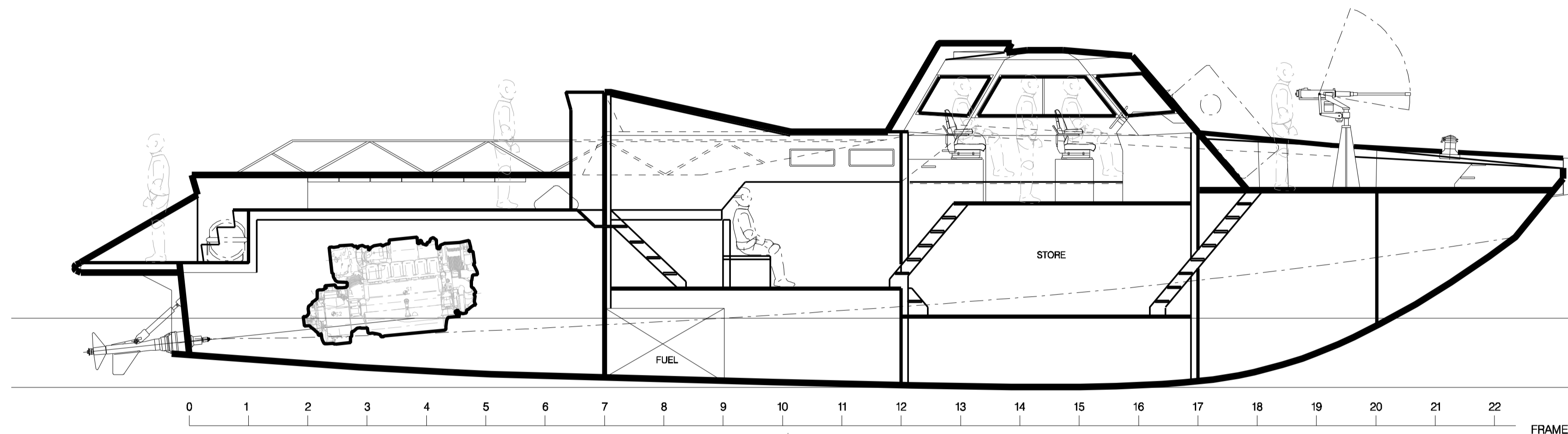
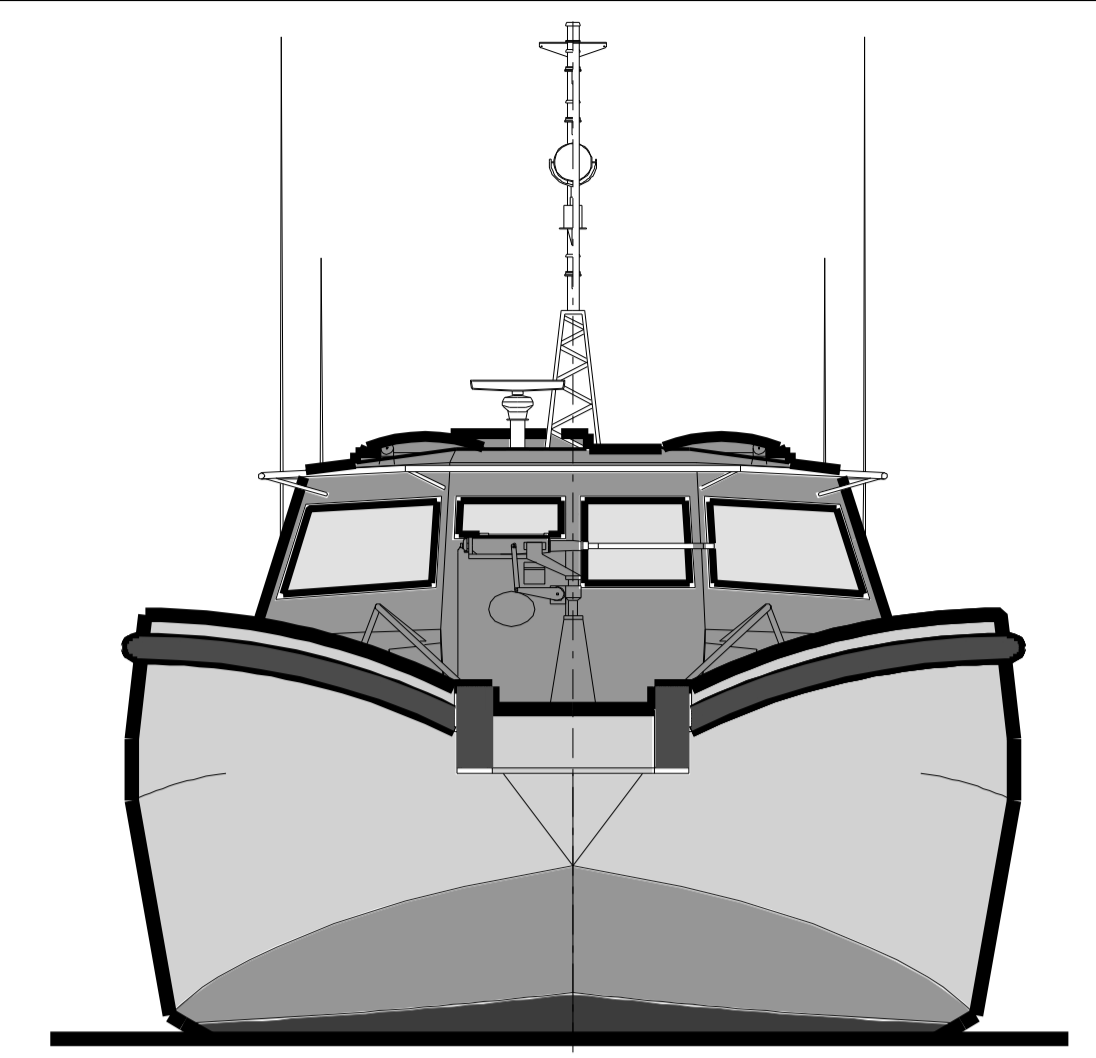

DWL

Baseline

INBOARD PROFILE

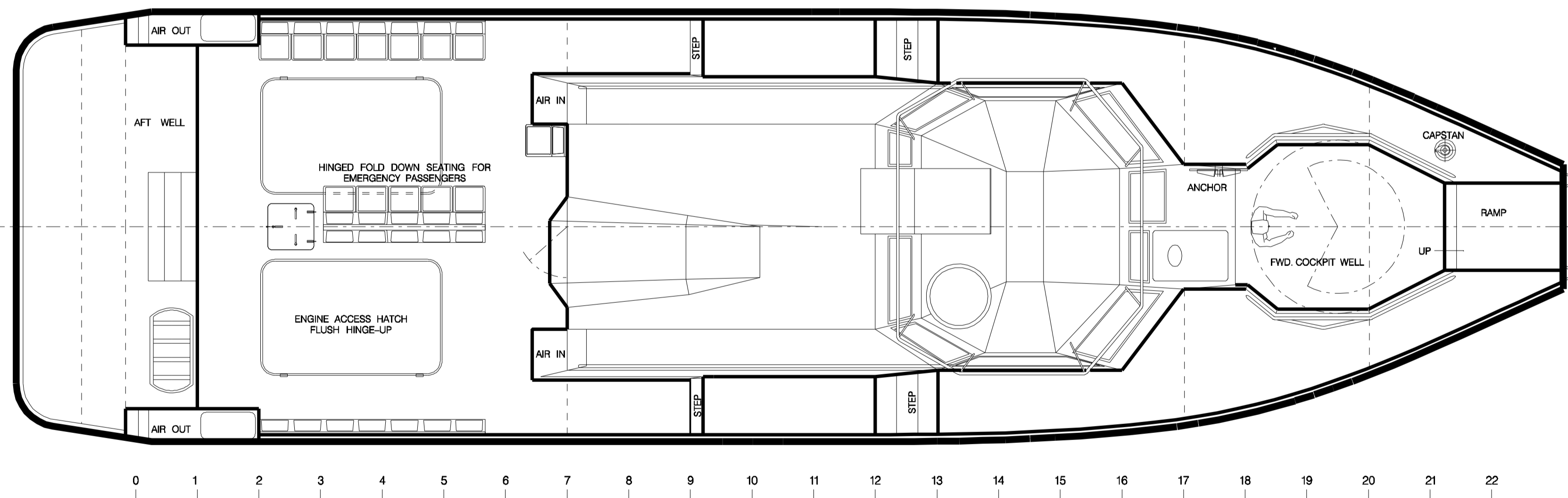

Q VESSEL

DECK PLAN

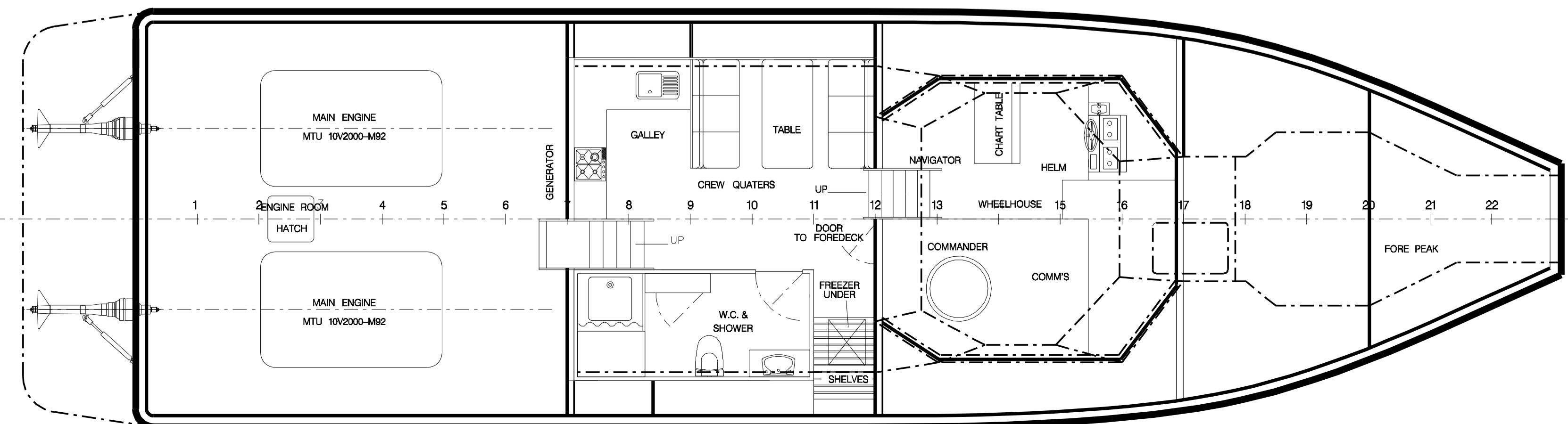

Q VESSEL

ACCOMMODATION PLAN

**Ad Hoc**  
Marine Designs Ltd.

Naval Architecture, Marine Design & Technical Support Services

[www.adhocmarinedesigns.co.uk](http://www.adhocmarinedesigns.co.uk)

# 17m COMBAT BOAT

General Arrangement

PRINCIPAL DIMENSIONS	
LOA (HULL)	18.70 metres
LWL	17.00 metres
Beam	5.90 metres
Draft	0.95 metres
Speed	45 Knots

SCALE 1:50

FPB 17-02-GA/01

PRIVATE AND CONFIDENTIAL © 2013

THIS DRAWING ISSUED BY AD HOC MARINE DESIGNS LTD. FOR THE PURPOSE OF RECORD ONLY AND ON THE EXPRESS TERMS THAT IT IS TO BE TREATED AS PRIVATE AND CONFIDENTIAL AND IS NOT TO BE COPIED OR COMMUNICATED TO ANOTHER PERSON